

### Armadio pensile a giorno

- Cod. **ARP 30120** mm 1140 x300x640h
- Cod. **ARP 30150** mm 1440 x300x640h
- Cod. **ARP 30180** mm 1740 x300x640h



### Armadio pensile ante cieche

- Cod. **ARP 30121** mm 1140 x300x640h
- Cod. **ARP 30151** mm 1440 x300x640h
- Cod. **ARP 30181** mm 1740 x300x640h

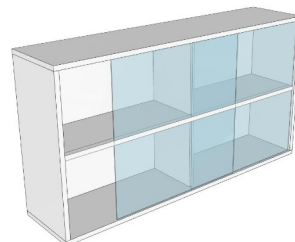

### Armadio pensile ante vetro

- Cod. **ARP 30122** mm 1140 x300x640h
- Cod. **ARP 30152** mm 1440 x300x640h
- Cod. **ARP 30182** mm 1740 x300x640h

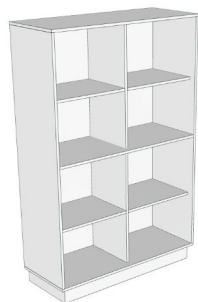

### Armadio a giorno

- Cod. **ARM 30090** mm 900 x480x1840h
- Cod. **ARM 30120** mm 1200 x480x1840h



### Armadio ante cieche

- Cod. **ARM 30091** mm 900 x500x1840h
- Cod. **ARM 30121** mm 1200 x500x1840h



### Armadio ante cieche+vetro

- Cod. **ARM 30092** mm 900 x500x1840h
- Cod. **ARM 30122** mm 1200 x500x1840h

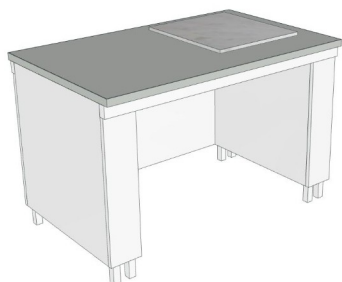

### Tavolo antivibrante

- Cod. **TAV 30060** mm 640 x750x770h
- Cod. **TAV 30090** mm 900 x750x770h
- Cod. **TAV 30120** mm 1200 x750x770h